

FITTING INSTRUCTION

Clamp mark in acc. with		Cables joining
ISO	PN	
1	L	Left directional lights
2	+	Rear fog lights
3	31	Ground
4	R	Right directional lights
5	58R	Right side parking lights
6	54	Stoplights
7	58L	Left side parking lights

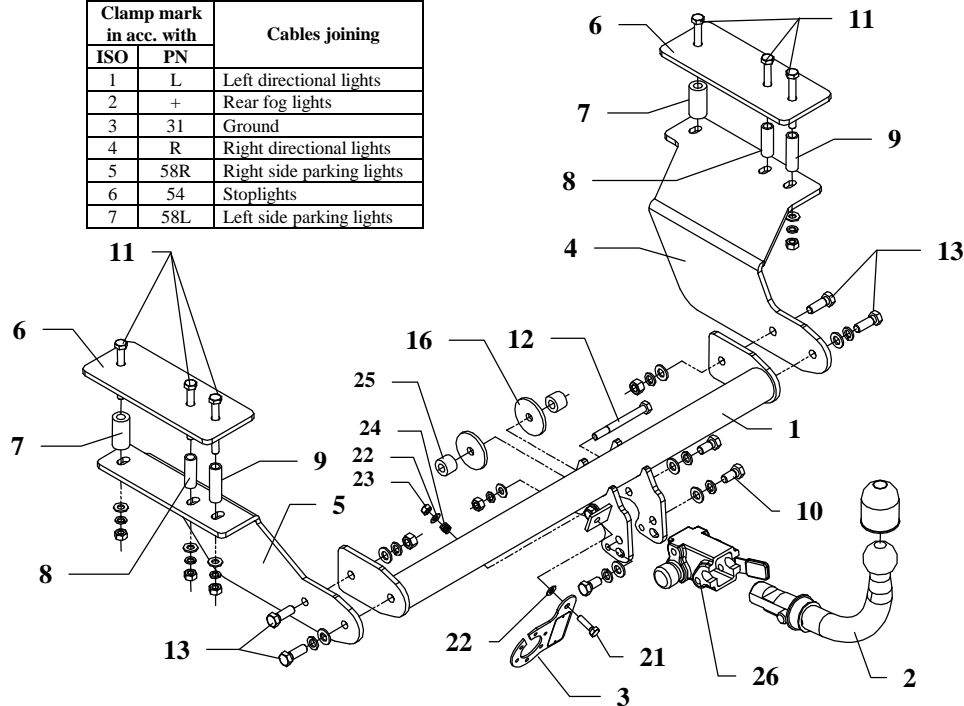

This towbar is designed to assembly in following cars:
KIA RIO, 5 doors, produced since 2000 till 2005, catalogue no. **T39A** and is prepared to tow trailers max total weight **1100 kg** and max vertical load **50 kg**.

Torque settings for nuts and bolts (8,8):

M6 - 11 Nm	M8 - 25 Nm	M10 - 50 Nm
M12 - 87 Nm	M14 - 138 Nm	M16 - 210 Nm

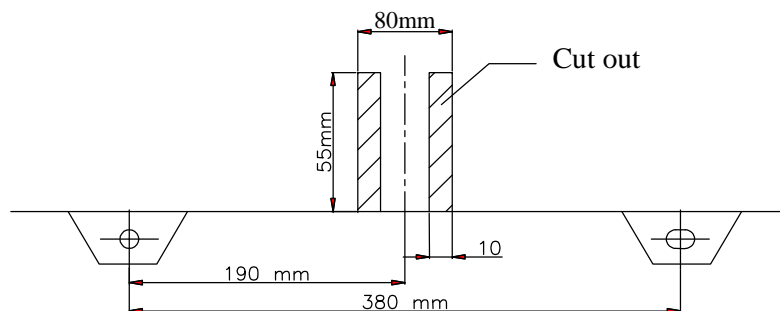
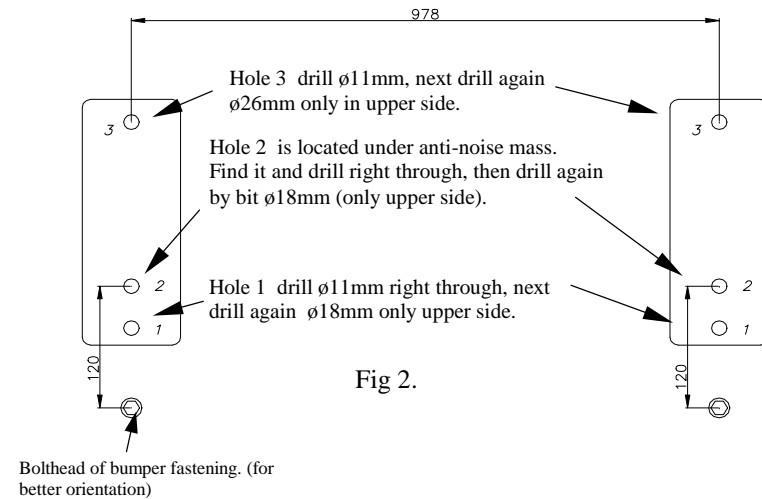

Fig. 3



The instruction of the assembly

1. Disassemble the bumper and cut out according to fig. 3.
2. In the boot, on the left and right side find original hole (are under anti-noise mass) (for help see fig. 2).
3. Place fish-plates D as show on fig. 2 (hole 2 must agree with original hole). Next drill holes 1 and 3 right through with bit $\phi 1$ mm.
4. Drilled holes 1 and 2 drill again with bit $\phi 18$ mm only in upper side. Hole 3 drill again with bit $\phi 26$ mm, in upper side too.
5. In this way prepared holes slip distance sleeves as show on fig. 1.
6. Put fish-plates (pos.6) and slip bolts M10x90mm (pos. 11) in holes.
7. On outstanding bolts (underneath the car) put elements pos. 4 (right side) and 5 (left side), fix loosely.
8. Between side brackets 4 and 5 put main bar and fix by bolts M12x35mm (pos. 13) from accessories.
9. Through holes in ball brackets fix original tow eye using bolt M10x100mm (pos. 12), use big washers $\phi 58 \times \phi 12 \times 5$ mm (pos. 16) and sleeves (pos.25).
10. Screw tight all bolts according to the torque shown in the table.
11. Reassemble the bumper.
12. Fix body of the automat (pos. 26) using bolts M12x25mm (pos. 10) from accessories. Place tow-ball (pos. 2) according to supplied instruction.
13. Fix the socket plate (pos. 3) as shown on the drawing.
14. Connect electric wires of 7-pole socket according to the instruction of the car. (Recommend to make at authorized service station)
15. Complete paint layer damaged during installation.

Towbar accessories:

Pos. 1 Name: Main bar Quantity: 1	Pos. 7 Name: Distance sleeve I Quantity: 2 Ø25xØ13, L=49	Pos. 14 Name: Nut 8 B Quantity: 2 Dim.: M12	Pos. 21 Name: Bolt 8,8 B Quantity: 1 Dim.: M8x30mm
Pos. 2 Name: Tow ball Quantity: 1	Pos. 8 Name: Distance sleeve II Quantity: 2 Ø17,2x2,35, L=49	Pos. 15 Name: Nut 8 B Quantity: 7 Dim.: M10	Pos. 22 Name: Plain washer Quantity: 2 Dim.: Ø 8,5 mm
Pos. 3 Name: Socket plate Quantity: 1	Pos. 9 Name: Distance sleeve III Quantity: 2 Ø17,2x2,35, L=58	Pos. 16 Name: Washer Quantity: 2 Dim.: Ø58xØ12x5mm	Pos. 23 Name: Nut 8 B Quantity: 1 Dim.: M8
Pos. 4 Name: Right bracket Quantity: 1	Pos. 10 Name: Bolt 8,8 B Quantity: 4 Dim.: M12x25mm	Pos. 17 Name: Plain washer Quantity: 8 Dim.: Ø 13 mm	Pos. 24 Name: Spring Quantity: 1
Pos. 5 Name: Left bracket Quantity: 1	Pos. 11 Name: Bolt 8,8 B Quantity: 6 Dim.: M10x90mm	Pos. 18 Name: Plain washer Quantity: 7 Dim.: Ø 10,5 mm	Pos. 25 Name: Distance sleeve IV Quantity: 2 Ø25xØ13, L=18,5
Pos. 6 Name: Fish-plate Quantity: 2	Pos. 12 Name: Bolt 8,8 B Quantity: 1 Dim.: M10x100mm	Pos. 19 Name: Spring washer Quantity: 8 Dim.: Ø 12,2 mm	Pos. 26 Name: Body of the automat Quantity: 1
	Pos. 13 Name: Bolt 8,8 B Quantity: 4 Dim.: M12x35mm	Pos. 20 Name: Spring washer Quantity: 7 Dim.: Ø 10,2 mm	Pos. 27 Name: Body plug Quantity: 1

NOTE

After install the towbar you should get adequate note in registration book (at authorised service station). The car should be equipped with:

- Indicators
- Tow mirrors

After 1000km check all bolts and nuts. The ball of towbar must be always kept clear and conserve with a grease



PPUH AUTO-HAK Sp.J.

Produkcja Zaczepów Kulowych
Henryk & Zbigniew Nejman
76-200 SŁUPSK ul. Słoneczna 16K
tel/fax (059) 8-414-414; 8-414-413
E-mail: office@autohak.com.pl
www.autohak.com.pl

Towing hitch (without electrical set)

Class: **A50-X** Cat. no. **T39A**

Designed for:

Manufacturer: **KIA**

Model: **RIO**

Type: **5 doors**

produced since 2000 till 2005

Technical data:

D-value: 6,4 kN

maximum trailer weight: **1100 kg**

maximum vertical cup load: **50 kg**

Approval number according to Directive 94/20/EC: **e20*94/20*1021*00**

Foreword

This towbar is designed according to rules of safety traffic regulations. The towing hitch is a safety component and can be install only by qualified personnel. Any alteration or conversion of the towing hitch is prohibited and would lead to cancellation of design certification. Remove insulating compound and underseal from vehicle (if present) in the area of the matting surfaces of the towing hitch.

The vehicle manufacturer's specifications regarding trailer load and max. vertical cup load are decisive for driving, and values for the towing hitch cannot be exceeded.

D-value formula:

$$\frac{\text{Max trailer weight [kg]} \times \text{Max vehicle weight [kg]}}{\text{Max trailer weight [kg]} + \text{Max vehicle weight [kg]}} \times \frac{9,81}{1000} = D \text{ [kN]}$$