

Kit 1032

MAZDA 323F, 5-dr Hatchback, 95-97

MAZDA Astina, 5-dr Hatchback, 95-97

MAZDA Lantis, 5-dr Hatchback, 95-97

480R
754

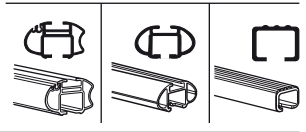
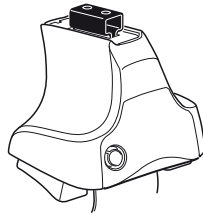

480

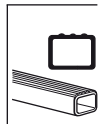
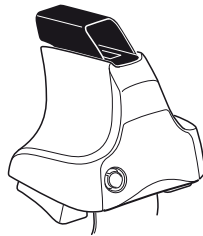

750

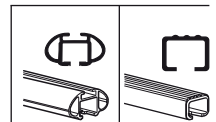
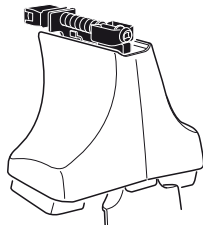

x2 x2 x2 x4	x2	x2 x2 x4 x4	x2 x2	x2

Kit



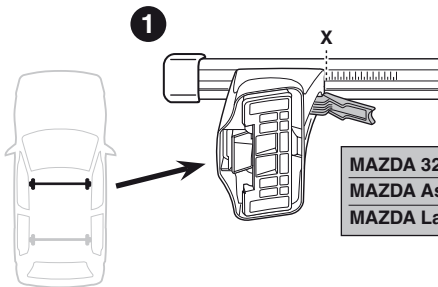

1

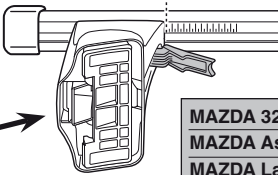

2



	X
MAZDA 323F, 5-dr Hatchback, 95-97	24
MAZDA Astina, 5-dr Hatchback, 95-97	24
MAZDA Lantis, 5-dr Hatchback, 95-97	24



1

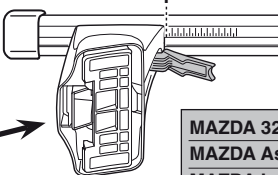

2

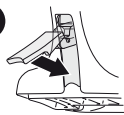

	Y
MAZDA 323F, 5-dr Hatchback, 95-97	22,5
MAZDA Astina, 5-dr Hatchback, 95-97	22,5
MAZDA Lantis, 5-dr Hatchback, 95-97	22,5

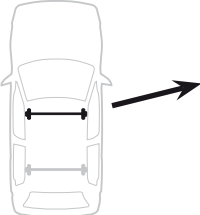
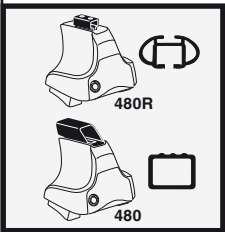

1

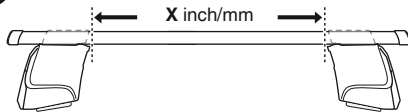

2



	X inch	X mm
MAZDA 323F, 5-dr Hatchback, 95-97	35 1/8"	891 mm
MAZDA Astina, 5-dr Hatchback, 95-97	35 1/8"	891 mm
MAZDA Lantis, 5-dr Hatchback, 95-97	35 1/8"	891 mm

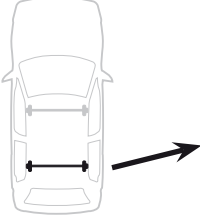

1

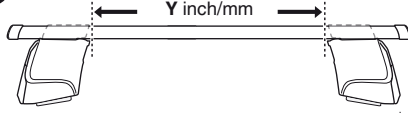

2



	Y inch	Y mm
MAZDA 323F, 5-dr Hatchback, 95-97	34 1/2"	876 mm
MAZDA Astina, 5-dr Hatchback, 95-97	34 1/2"	876 mm
MAZDA Lantis, 5-dr Hatchback, 95-97	34 1/2"	876 mm

4

MAZDA 323F, 5-dr Hatchback, 95-97
MAZDA Astina, 5-dr Hatchback, 95-97
MAZDA Lantis, 5-dr Hatchback, 95-97

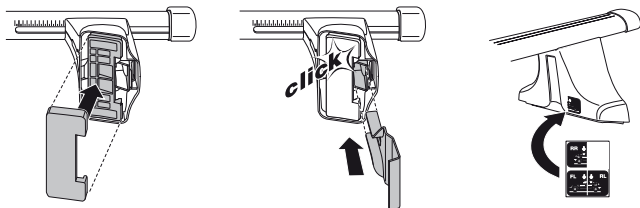
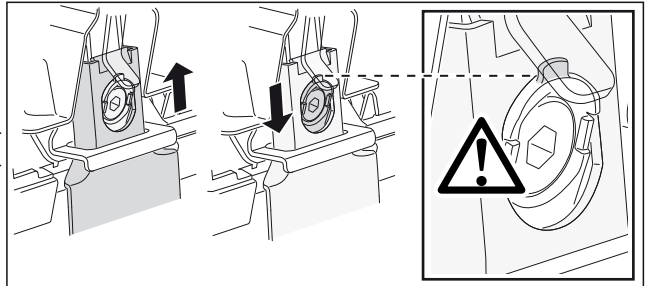
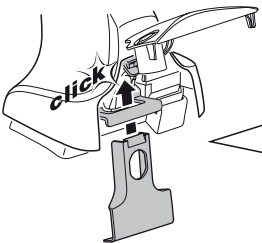
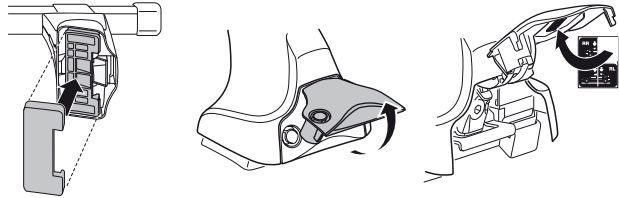
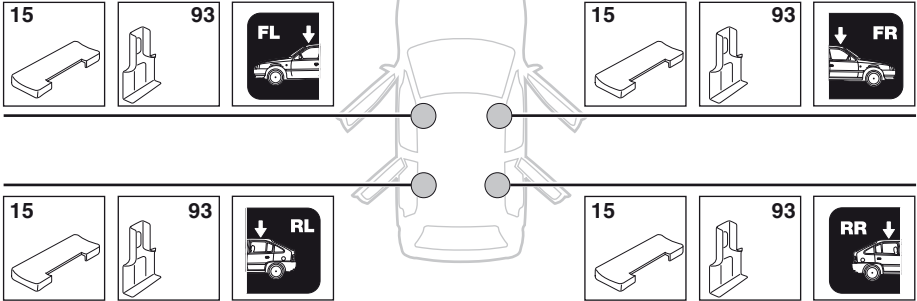

5



	X mm	Y mm	X inch	Y inch
MAZDA 323F, 5-dr Hatchback, 95-97	220 mm	650 mm	8 5/8" "	25 5/8" "
MAZDA Astina, 5-dr Hatchback, 95-97	220 mm	650 mm	8 5/8" "	25 5/8" "
MAZDA Lantis, 5-dr Hatchback, 95-97	220 mm	650 mm	8 5/8" "	25 5/8" "

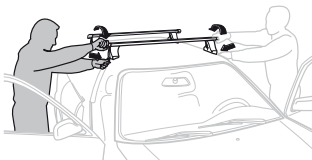
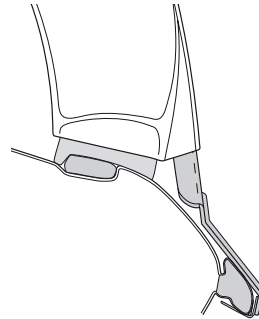
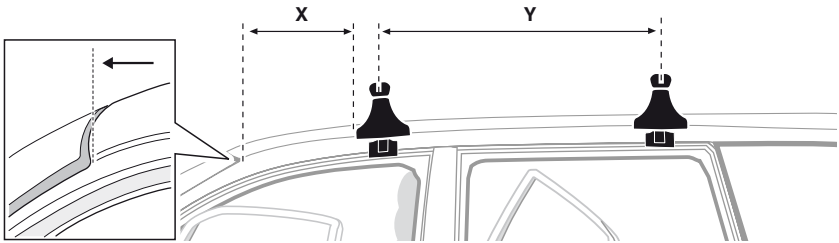

GB/US Tighten alternately
D Die Schrauben abwechselnd anziehen
F Serrer alternativement chaque côté
NL Afwisselend aan de linker- en de rechterkant aandraaien
I Alternare il serraggio delle viti
E Apretar alternativamente
PT Aperte alternadamente
S Dra åt växelvis
FIN Kierrä vuorotellen
EST Pinguldage vaheldumisi
LAT Pievelciēt pamīšus
LIT Užsukinėkite pakaitomis
PL Śruby dokręcaj naprzemiennie
RU Затягивайте попеременно

CZ Pokręťla багаžníka dokręcaj dokręcaj naprzemiennie.
SK Doťahujte striedavo
SLO Privijajte izmenično.
HR Naizmjenično zategnite
HU Egymástól függetlenül szorítandó
GR Σφιγγετε εναλλάξ
TR Dönüşümlü sıkın

中文 交替拧紧

한국어 번갈아 가며 조이십시오.

日本語 交互に締め付けてください。

ไทย ขันในแบบสลับ

6



480R/754



480

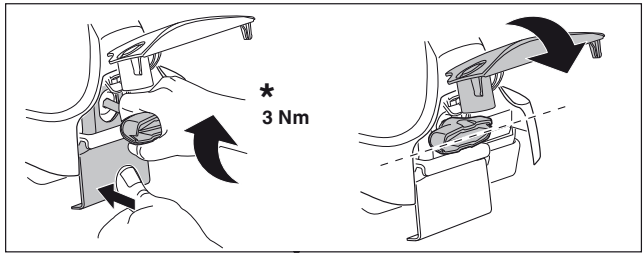

*
3 Nm



*



*
≈ 3 Nm

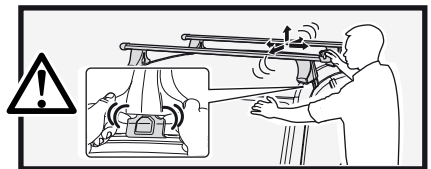

750

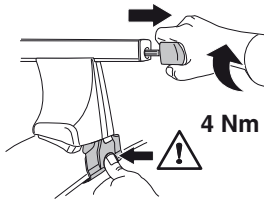

4 Nm

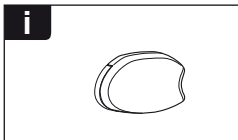
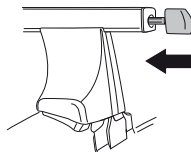

i

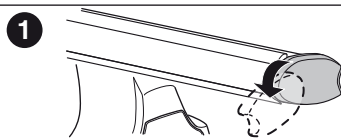

1

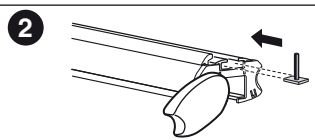

2

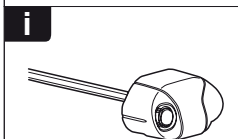

i

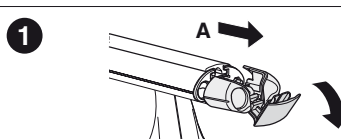

1

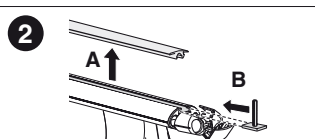

2

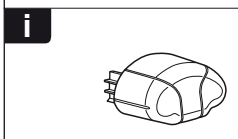

i

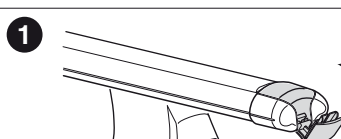

1

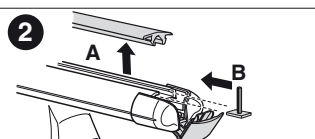





2



THULE
SWEDEN
**ONE
KEY
SYSTEM**



-  **544** (x4)
 -  **596** (x6)
 -  **588** (x8)
 -  **510** (x10)
 -  **452** (x12)
- NA
EUR
ASIA



WW ▶ Thule Sweden AB, Box 69, 330 33 Hillerstorp, SWEDEN
NA ▶ Thule Inc., 42 Silvermine Road, Seymour, Connecticut 06483, USA

info@thule.com
customer.service@thule.com

 www.thule.com